

TERMINALES DE COBRE ESTAÑADO - CAÑÓN LARGO

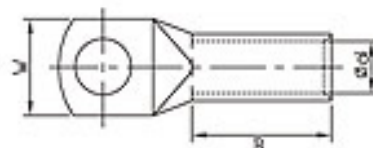
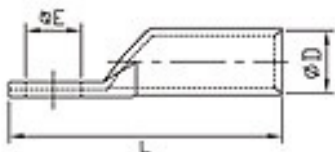

Ítem	Agujero		Tamaño del terminal				Tamaño de cable		
	φE	Pulg.	φD	W	B	L	φd	AWG	mm ²
TL10-6	6.4	1/4"	6.9	11.9	19.0	35.0	4.7	8	10
TL10-8	8.3	5/16"	6.9	13.5	19.0	38.0	4.7	8	10
TL16-6	6.4	1/4"	7.8	11.9	23.0	39.0	5.6	6	16
TL16-8	8.3	5/16"	7.8	13.6	23.0	42.0	5.6	6	16
TL16-10	10.5	3/8"	7.8		23.1		5.6	6	16
TL25-8	8.3	5/16"	9.5	14.0	29.0	50.0	7.1	4	25
TL25-10	10.5	3/8"	9.5	16.0	29.0	53.0	7.1	4	25
TL25-12	10.5	3/8"	9.5		29.0		7.1	4	25
TL35-10	10.5	3/8"	11.0	16.5	30.0	58.0	8.2	2	35
TL50-10	10.5	3/8"	12.5	17.9	35.0	64.0	9.5	1	170
TL50-12	13.0	1/2"	12.5	17.9	35.0	64.0	9.5	300mcm	170
TL70-10	10.5	3/8"	15.0	21.5	38.0	70.0	11.5	2/0	70
TL70-12	13.0	1/2"	15.0	21.5	38.0	70.0	11.5	2/0	70
TL95-12	13.0	1/2"	16.9	24.7	46.0	79.0	13.5	3/0	120
TL120-12	13.0	1/2"	19.9	28.9	51.0	87.0	15.6	4/0	150
TL150-12	13.0	1/2"	20.9	30.4	56.0	99.0	16.5	250mcm	170
TL185-12	13.0	1/2"	23.7	34.0	62.0	108.0	18.8	350mcm	240
TL240-16	16.5	5/8"	26.4	38.5	66.0	119.0	21.2	400mcm	300
TL300-16	16.5	5/8"	28.6	41.7	75.0	132.0	23.4	500mcm	350
TL400-16	16.5	5/8"	32.8	48.0	71.7	140.0	26.8	750mcm	